

Front seats (3-door vehicles)

Removing and installing rear cover on front seat rail (inboard side)

1. Cover (inboard side)

□ Removing

- Push one finger underneath cover inboard side -1- (direction of arrow -A-) and press the retainer tab -2- in direction of arrow -B-.
- At the same time pull front cover inboard side -1- in direction of arrow -C-.

□ Installing

- Enter the cover inboard side -1- press onto carpet and at the same in direction of arrow -D-.
- Enter guides -4- into guide rail-6-.
- The lugs -3- and -5- must engage in the

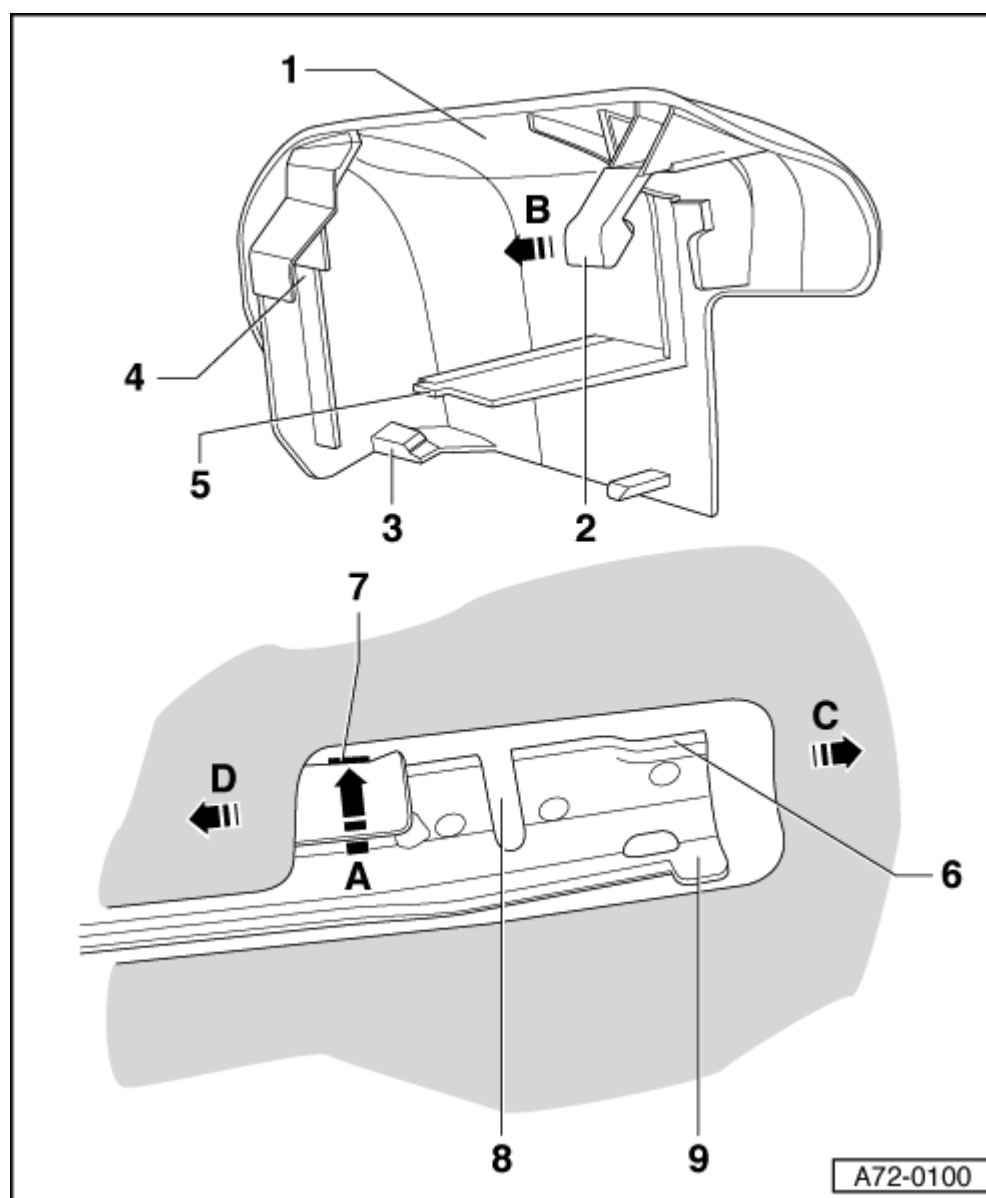

metal tab -
9- and
the
mount -
8-.

□ Press in
cover
inboard
side -1-
until the
locking
lug -2-
engages
in cut-
out.

- 2. Retainer tab
- 3. Retainer tab
- 4. Guide
- 5. Retainer tab
- 6. Mounting
- 7. Cut-out
- 8. Mounting
- 9. Metal tab

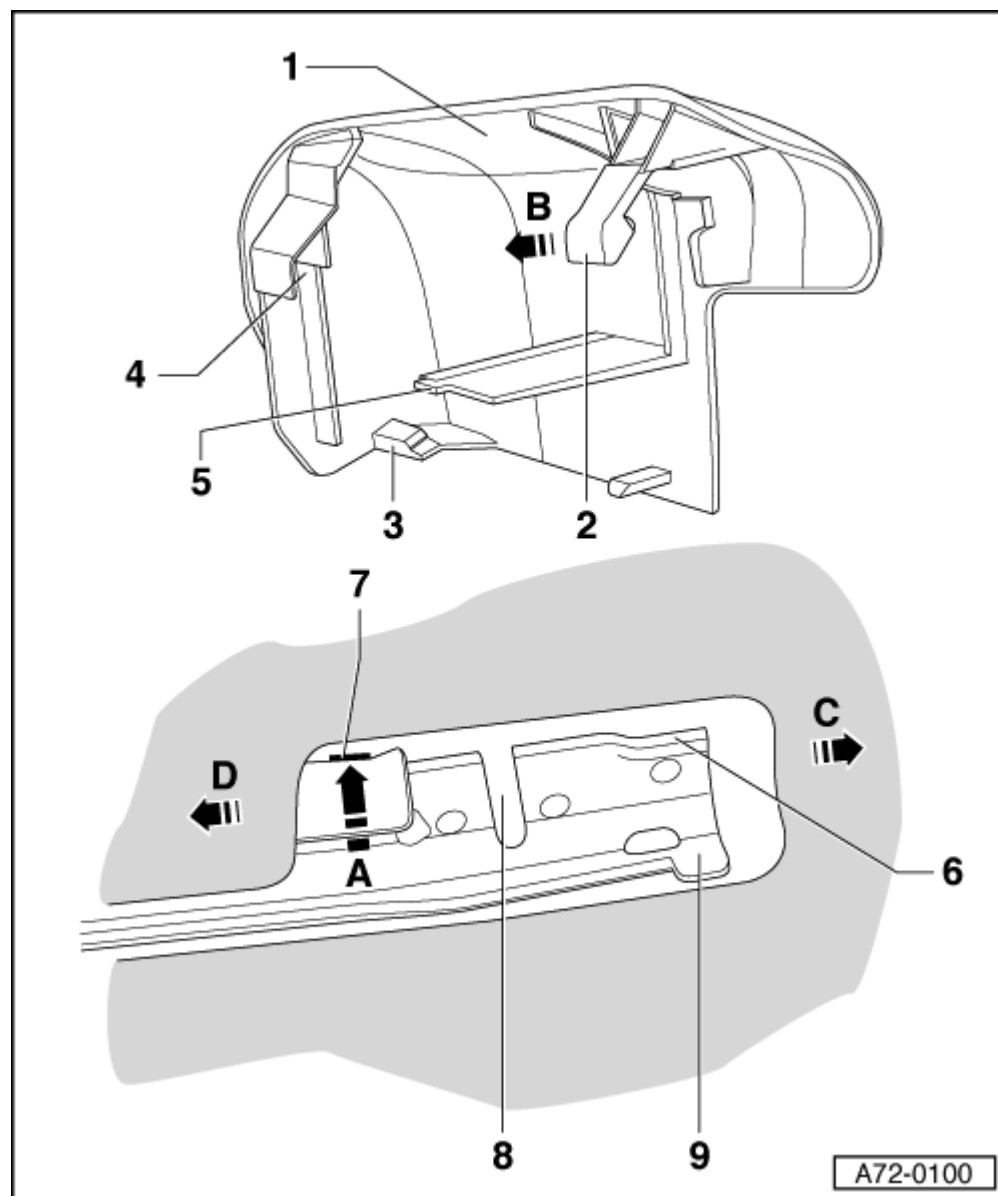

A72-0100