

Front door

Removing and installing door shell and door component carrier

1. Outer window slot seal

- ◆ Removing and installing => Page [66-30](#)

2. Door component carrier

- ◆ Removal:
 - Remove front door trim => Page [70-1](#).
 - Unclip Bowden cable for interior door control.
 - In vehicles with electric windows and/or adjustable exterior mirrors, disconnect connectors.

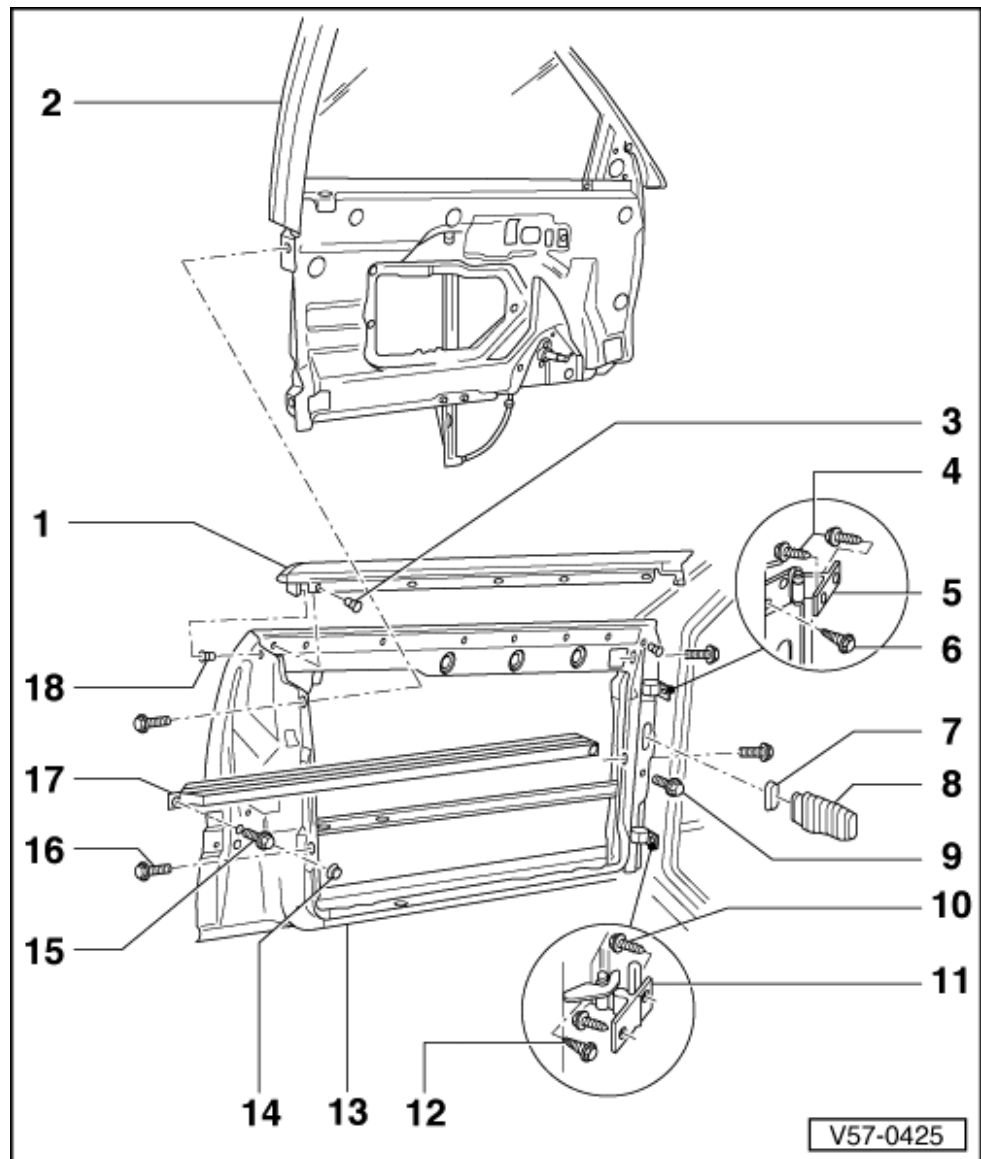

- Unscrew hexagon screws - item [16](#) - and withdraw door component carrier upwards.
- ◆ Adjusting => Page [57-30](#)
- ◆ After installing door component carrier always check upper stop

limit of door window and adjust as necessary => Page [57-13](#)

- 3. **Clip**
 - ◆ 6 off
- 4. **Hexagon screw - 30 Nm**
 - ◆ 2 off
- 5. **Top door hinge**
- 6. **Hexagon screw - 30 Nm**
 - ◆ 2 off
- 7. **Grommet**

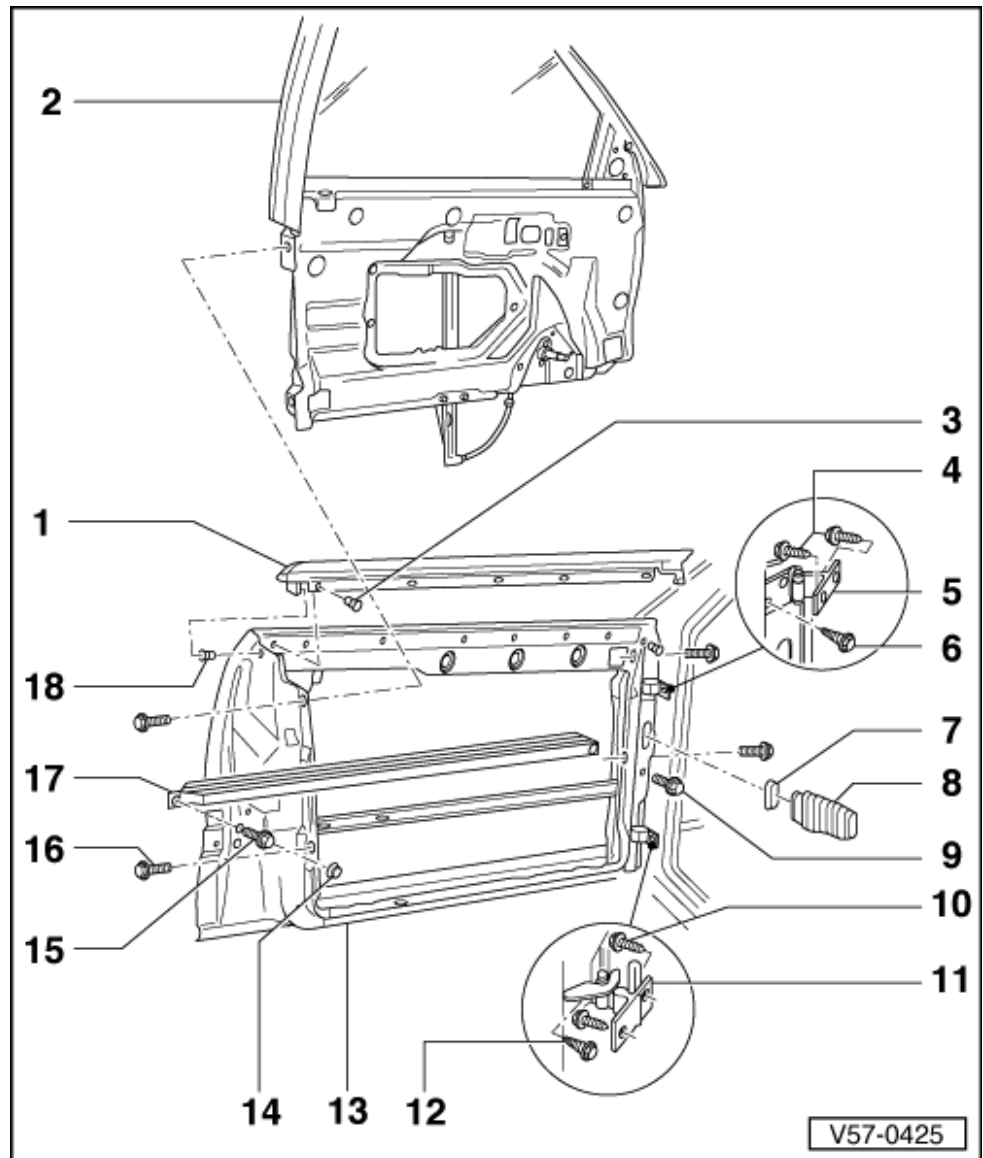

- 8. **Bellows**
- 9. **Combi screw - 6 Nm**
- 10. **Hexagon screw - 30 Nm**
 - ◆ 2 off
- 11. **Bottom door hinge**
 - ◆ Grease new part; greasing points => [Fig.1](#)
- 12. **Hexagon screw - 30 Nm**
 - ◆ 2 off
- 13. **Door shell**
 - ◆ Removal:
 - Disconnect connectors.
 - Detach and unclip hose line for central

- locking from door lock.
- Unscrew screws - item [6](#)- and -item [12](#)-
- ◆ Adjusting => Page [57-29](#)

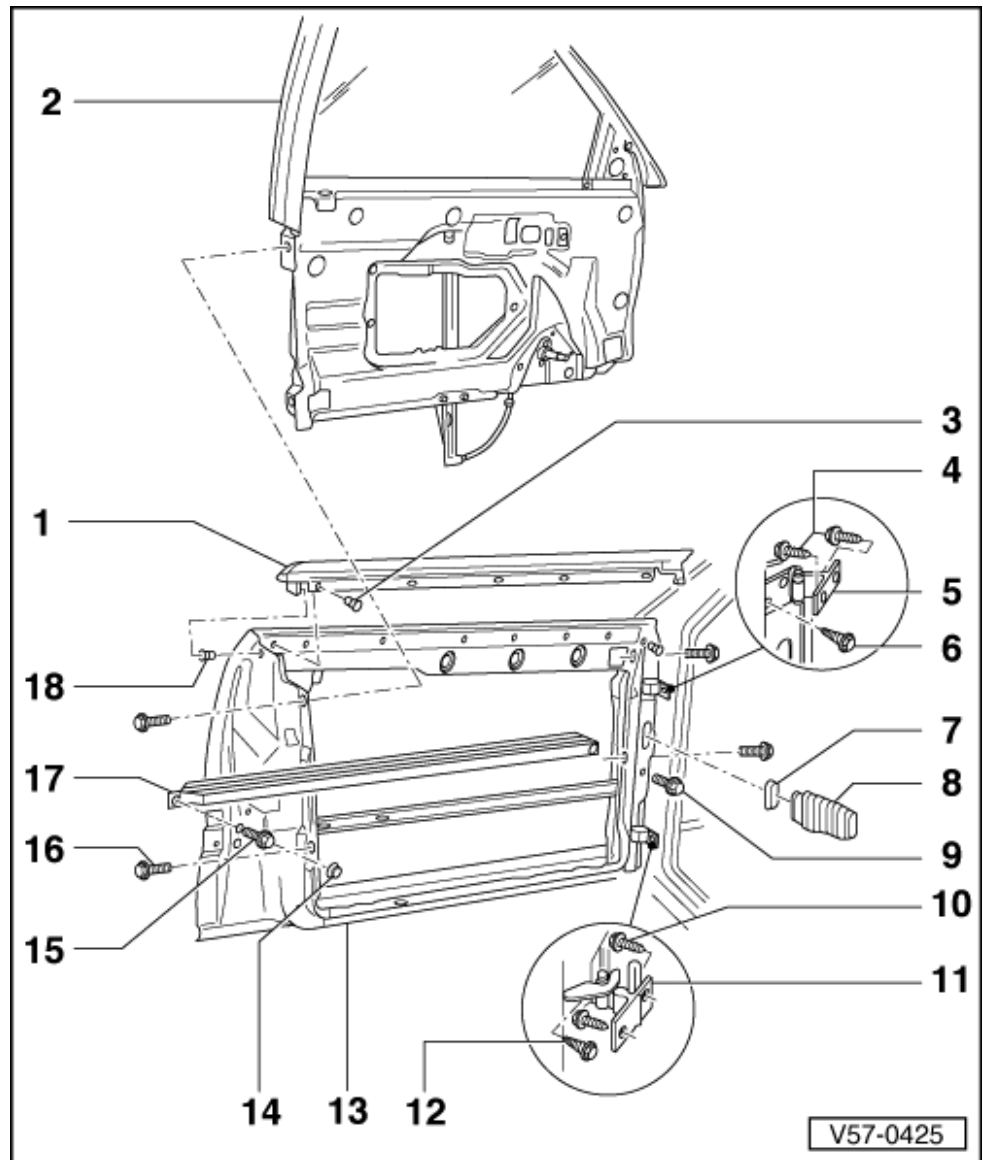

- 14. Screw head cap
- 15. Combi screw - 8 Nm
- 16. Hexagon screw - 30 Nm
 - ◆ 4 off
- 17. Impact bar
 - ◆ Removing and installing impact absorber => Page [57-7](#)
- 18. Grommet
 - ◆ 2 off

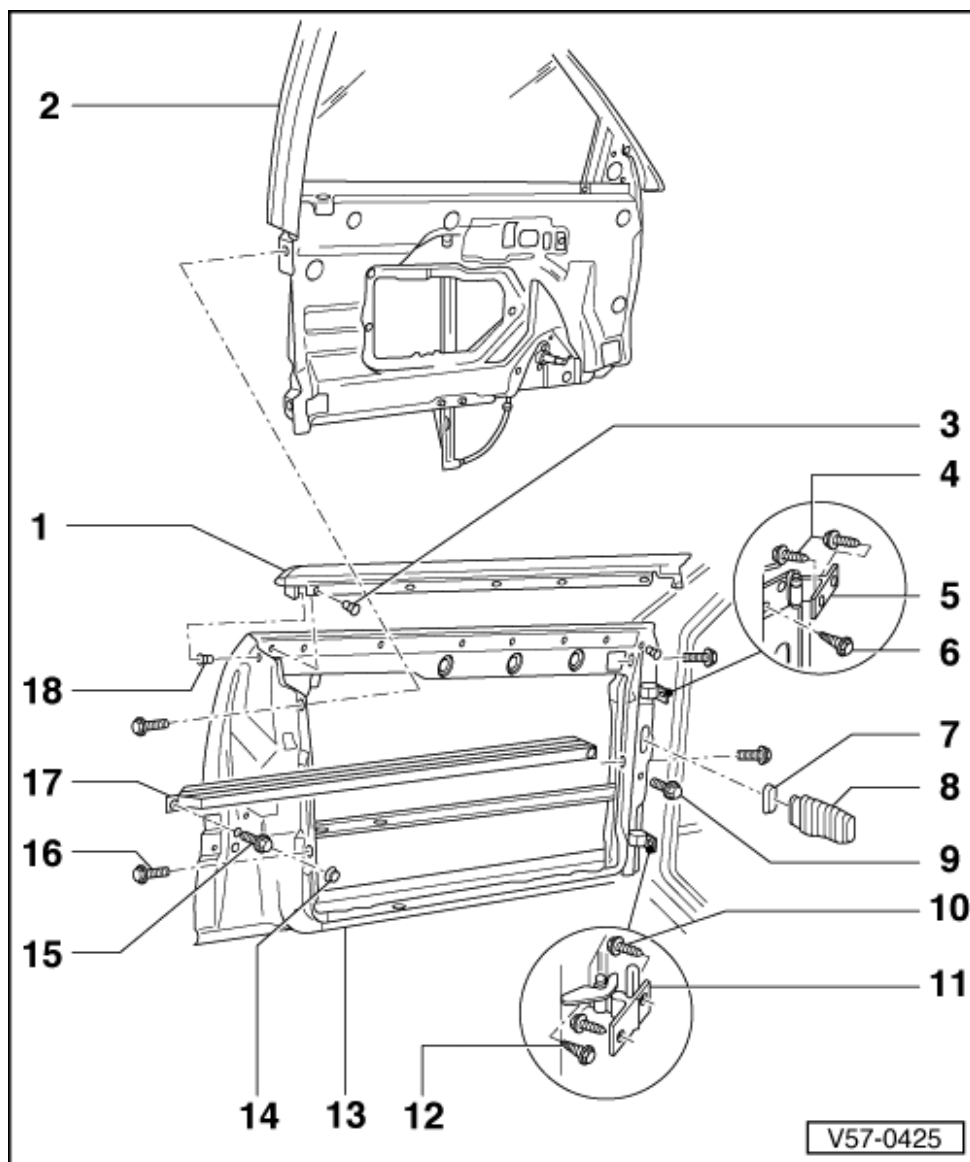

→ Fig.1 Bottom door hinge - greasing points

- Coat arrester -arrows- with grease G 000 400.

